

Puchong Financial Corporate Centre (PFCC)

DETAILS

Location: **Bandar Puteri Puchong**

Min. Price: **4.00 psf**

Min. Size: **2,500 sq ft**

Max. Price: **4.50 psf**

Max. Size: **15,000 sq ft**

AMENITIES

- Parking
 - 24hr Security
 - CCTV
 - Mini Market
 - Cafeteria
-

DESCRIPTION

PFCC is a finance and corporate zone comprising 4 office towers and a 4-star international hotel. A premier destination for business, PFCC also features quality interior finishes, grand drop-off and concourse reception, and panoramic views that make PFCC an iconic corporate landmark in Puchong.

PFCC strategically located at Bandar Puteri Puchong, which is a mature and thriving township filled with a wide variety of businesses and services, as well as social and recreational facilities. There is a pedestrian link bridge connecting to Taman Perindustrian Puchong (TPP) LRT Station, and is easily accessible to major highways such as Ldp, KESAS, and ELITE Highway.

Key Features:

- Located at Puchong thriving township
- MSC status for Tower 2, 4 & 5
- Green building certified with GBI
- Covered link bridge to LRT station
- Landscaped promenade with alfresco F&B

- Adjacent to Four Points by Sheraton Hotel
- Surrounded to various amenities & eateries
- 24-hour CCTV surveillance & security personnel patrol
- IT infrastructure ready with CAT 6 cabling
- Fibre optics backbone facilities
- High speed internet access
- Underground air conditioning
- Dedicated shuttle lifts to car parks

Building Specification:

Year Built	2013
Passenger Lift	<ul style="list-style-type: none"> - Tower 1: 5 no. - Tower 2: 4 no. - Tower 4: 6 no. - Tower 5: 6 no.
Parking Facilities	<ul style="list-style-type: none"> - Tower 1: 139 bays - Tower 2: 413 bays - Tower 4: 3-level basement car park - Tower 5: 3-level basement car park
MSC Status	Yes (Tower 2, 4 & 5)
Green Building	GBI

Nearby Amenities

Shopping Mall :

- 0.9 km SetiaWalk Mall
- 4.5 km IOI Mall Puchong

Hotel :

- 0.0 km Four Points by Sheraton Hotel (4-star)

Public Transport:

- 1.1 km LRT Taman Perindustrian Puchong Station

Medical Centre / Hospital

- 0.7 km KPMC Puchong Specialist Centre
- 1.5 km Columbia Asia Hospital Puchong

Similar Listing

IOI City Tower

<http://www.cbdooffice.com.my/office/ioi-city-tower>

Menara MBMR

<http://www.cbdooffice.com.my/office/menara-mbmr-0>

MCMC Tower

<http://www.cbdooffice.com.my/office/mcmc-tower>

**PFCC ???? 4???? ? 1?4?????? ???? ?????????? ???? ??Bandar Puteri
Puchong? ????????????????????**

????

? ??????

- ?? ?????????????????????
- ?????????????????
- ???? LDP?KESAS ? ELITE ??

? ?????????

- Tower 2?4 & 5 ? MSC Cybercentre ?????????
- GBI ?????????????
- CAT 6 ?? + ?????????????

? ???????

- ??????????Four Points by Sheraton?
- ???? + ??????????????
- ??????????????
- ??????????????

? ???????

- 24????? + ?????
- ??????Tower 1: 5? / Tower 2: 4? / Tower 4 & 5: ?6??

????

??	??
????	2013
????	?????5? ?????4? ?????6? ?????6?
?????	?????139? ?????413? ?????3????? ?????3?????
MSC ??	?????????????

??????	GBI ??
--------	--------

????

?? ?????

- 0.9?? | **SetiaWalk ??**

- 4.5?? | ?? IOI ?????

? ?????

- 0? | ???????????4???

? ?????

- 1.1?? | ???????????

? ?????

- 0.7?? | **KPMC??????**

- 1.5?? | **Columbia Asia????**

GOOGLE MAP

Click [HERE](#) to link to google map

GALLERY



TYPICAL FLOOR PLAN



TOWER 1 (12 Storeys)
13,078 sq. ft.



TOWER 2 (20 Storeys)
12,788 sq. ft.

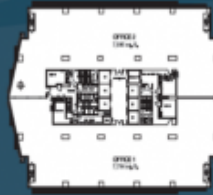

**TOWER 4
(18 Storeys)**
15,319 sq. ft.



**TOWER 5
(21 Storeys)**
12,522 sq. ft.

